



This is where luxury comes naturally.



UTTAM GROUP

**Office Address :**

E-172 A, Ramesh Marg, C-Scheme, Jaipur  
440, Officers Campus, Vaishali Nagar, Jaipur - Phone :+91 141 2359435  
Email : [info@uttamgroup.in](mailto:info@uttamgroup.in) | Website : [www.uttamgroup.in](http://www.uttamgroup.in)

**For Bookings:**

+ 91 7742919516, 8104069145

Designed by **bfc**

UTTAM'S  
*H De*  
A new dimension in luxury lifestyle  
Super Luxury Residences

*Lavish lifestyle*  
*Magnificent living*





**UTTAM GROUP**

Innovative Classic Elegant

A brand with impeccable credentials, "Uttam Group, understands what comfort, luxury and style means to you. Their impact on life is all-encompassing, be it the comfort of a home, recreation or space to learn and grow. One of the Key players in Jaipur's real estate market, "Uttam Group" is a symbol of Quality, Trust & Integrity. Through its commitment to quality, innovation & personalized services, we have ensured the buyer has sufficient faith and confidence in the group. We are passionate about real estate and providing our clients with the best possible experience when it comes to buying and selling property with 'Uttam Group'.



Soar High with...

Innovation      Reliability  
 Speed              Flexibility      Quality  
 Service              Performance      Strength



## Location whereabouts

Located at the prime residential hub of Jaipur makes this residency a dream destination for premium customers. Everything is just a heartbeat away. Both necessities and privileges are within easy reach, with the International Airport, Railway Station, Bus Stand and other important places just few kms. away.

### Distances :

International Airport :	10 min drive
Railway Station :	15 min drive
Bus Stand :	15 min drive
Hospital :	Walking distance
Bansal Classes/Allen :	Walking distance
Central Academy School :	Walking distance
Jain Mandir :	Walking distance
Ayappa Mandir :	Walking distance
Banks:	Walking distance

### Location Map



Not to scale





Savour the moment.  
 It's priceless.



## About the project

Uttam's Bhudev, the most happening 'luxurious' place in town & the hub of good times, is where we build comfort. The approach of the complex is the purity and beauty of nature, by fusing modern architecture with a living environment, without leaving any detail aside. Here you will find sensational landscape, privacy, facilities, harmony and ample living spaces, & integration with nature to enrich your overall experience . At Uttam,s Bhudev' you will enjoy unmatched proximity to well designed entrance lobby with 2 automatic lifts. It has ample car parking with the plot being surrounded by 3 side open road and much more is what you will find at this condominium adding the value of '**LOCATION, LOCATION and LOCATION**'.



Luxury  
 Beyond your  
 Dreams...







Gymnasium

## Club House



Multipurpose Hall



Meditation Hall



Card Room

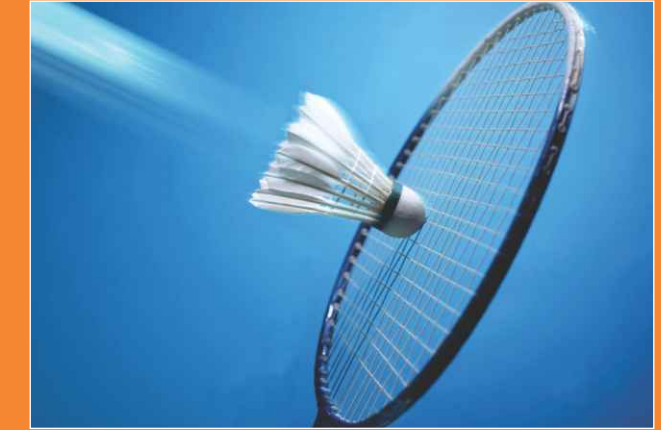

Badminton

## Club House

The Club house at Uttam's Bhudev is the main facility designated, for exercise and fitness. It provides the community with a fully equipped meditation hall and a comprehensive program of group and individual exercise classes. The Club house is comprised of swimming pool, card room, badminton, TT table, etc., The Club house includes a gymnasium and separate equipment room. All members have access to the Club house.



Swimming Pool



Table Tennis



Carrom



## Enrich Life Beautifully

Beyond the world of scores, marvel in the games to enrich life beautifully. The place which you would cherish with your loved ones....





## Project Highlights

### Eco Friendly Feature

Building designed as per eco friendly concept, big windows for better air, light & cross ventilation.



### Multipurpose Hall & Club House

Multipurpose hall for the use of flat owners. Children play area having slide, swing, see-saw & selection of indoor games.



### Rain Water Harvesting System

Rain water harvesting system to recharge ground water, surface water of the complex is planned to be collected in underground water tanks.

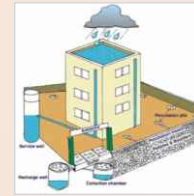

### Security & Safety

CCTV, Intercom system for 24 hrs. monitored access to complex, Earthquake resistant RCC frame structure.



### Water Supply System

24 hrs. water supply.



### Parking

Ample car parking, covered & open.



### Vertical Transportation

2 high speed Idiomatic lift with power backup.



## Specification & Features

### The Building

Three side road with elegant designs that epitomize charm and bliss. Vaastu compliant structures with best possible ventilation, space utilization & earthquake resistance..

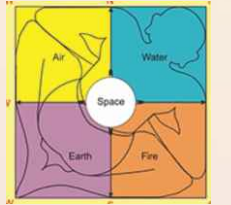

### Special Features / Facilities

Provision of wardrobe in all bedrooms, spacious wide balconies and wide windows in each flat. Landscape areas with lush green garden & society office.



### Finishing

Exclusive designer vitrified flooring in drawing, dining area, kitchen and bedrooms, POP base with easy clean paint.



### Wood Work

Designer laminated flush/designer compressed doors, Aluminum / UPVC windows.



### Kitchen

Modular kitchen with granite counter top, anti scratch stainless steel sink & 2 ft. tiles above the counter area.



### Toilet

Premium grade C.P. fittings, designer ceramic glazed tiles on walls, anti-skid tiles on flooring, branded sanitary ware's.



### Electrical

Premium quality switches and accessories  
 TV/Telephone/A.C. piping in all rooms at appropriate places, Power backup for lift.







Stilt Floor Plan







## Typical Floor Plan



Typical Floor Plan ( 1st to 4th Floor)

Flat No	101	102	103	104	105	106	107
Saleable Area	1410 sq.ft.	1620 sq.ft.	1555 sq.ft.	1200 sq.ft.	1137 sq.ft.	1632 sq.ft.	1595 sq.ft.
Flat Type	3 BHK	3 BHK	3 BHK	2 BHK	2 BHK	3 BHK	3 BHK

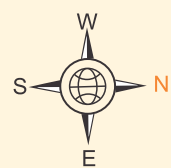



**Unit Plan 2 BHK**

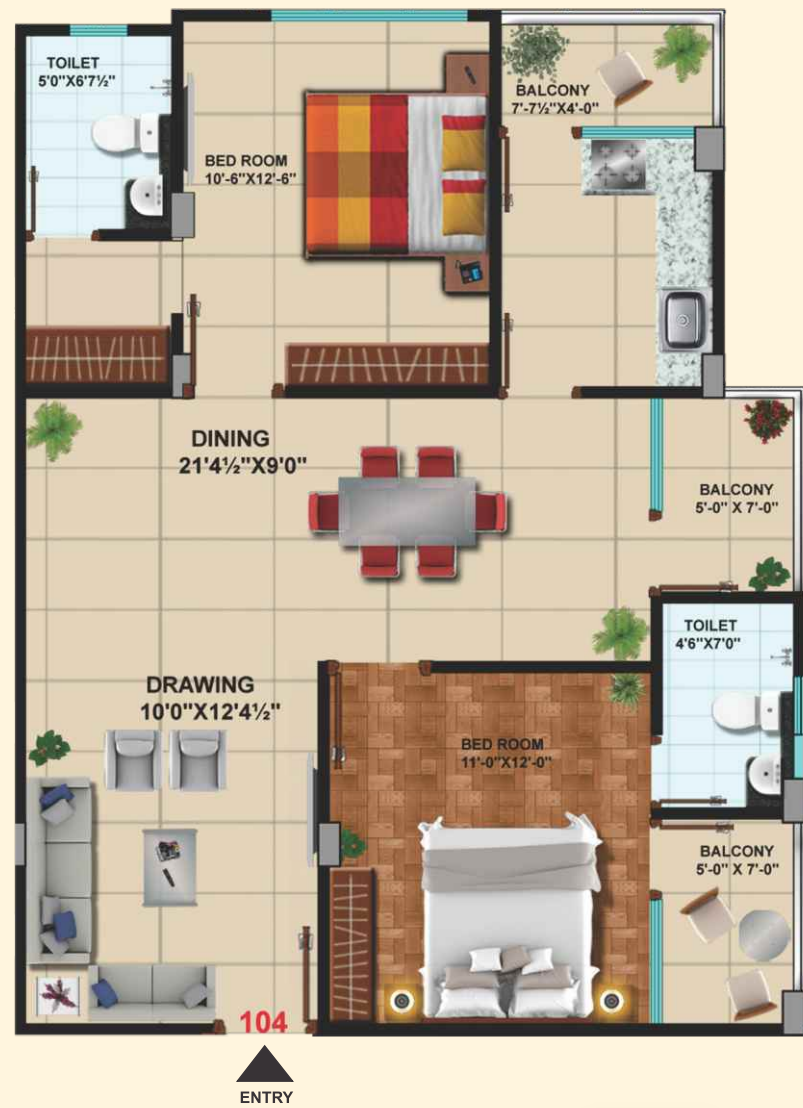

Type : 2 BHK  
 Flat No. 104  
 Saleable Area : 1200 sq. ft.



**Unit Plan 3 BHK**



Type : 3 BHK  
 Flat No. 103  
 Saleable Area : 1555 sq. ft.

